



### Sampling-funnel

#### SEC-SF-ABS

Sampling-funnel for tubes TU 25XXX. For sampling points exposed to high air current like monitoring of server racks or air conditioners.

#### Technical data

Pipe connection:	25 mm
Hole diameter:	5 mm
Material:	ABS

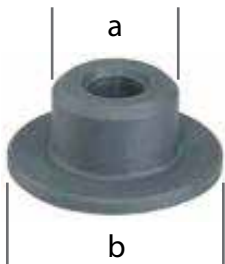

### Rosette for sampling tube stiff

#### SEC-SP-36-PVC

#### SEC-SP-36-ABS

For tubes TU 25 PVC/ABS to create the sampling point type "sampling tube stiff with rosette". Has to be glued into the tubes TU 25 PVC or ABS. Various outer diameters (b) on demand available.

#### Technical data

Diameter a:	21.5 mm
Diameter b:	36 mm
Material:	PVC / ABS
Packaging unit:	10 pieces



### Sampling point for ceiling duct

#### SEC-SP-M20-PVC

#### SEC-SP-M20-ABS

Sampling point for ceiling ducts to connect flex sampling pipe (FT 21 PA.). To connect the flex sampling pipe FT 21 PA. Inclusive self sealing coupling SC 20ST PA.

#### Technical data

Material:	PVC / ABS
Colour:	white / grey
Diameter:	M20, 36mm



### Sampling point for ceiling duct (Set)

#### SEC-SP-M20-PVC-Set

#### SEC-SP-M20-ABS-Set

Sampling point for ceiling ducts. Complete set incl. T-Piece TP 25XXX, flex sampling pipe (FT 21 PA) and sampling point (SP M20 XXX).

#### Technical data

Material:	PVC
Length sampling stub:	0.8 m



### Sampling point Capillary (set)

#### SEC-SP-TU6-PVC-Set

To create the sampling point type "Capillary". Complete capillary tube-set for the installation in sampling pipes TU 25 PVC. Incl. T-piece TP 25 PVC, reduction RE 25-6 PVC and capillary stub 1.5m.

#### Technical data

Length:	1.5 m
Colour:	gray, RAL 7011
Diameter outside:	6 mm
Diameter inside:	4 mm